

MADE IN ITALY



FLOODED - FREE MAINTENANCE BATTERY										
Code	Voltage	Capacity	Cold Cranking	Res. Cap.	Tester	Terminal	Box	Bottom holds	Layout	Per Pallet
	V	Ah 20h	A (EN)	Minutes		Conical				
B092C	12	85	760	140 (25A)	790	1 standard	L4B	B13	+ right	14x4=56

TOP ENERGY EVO

Classification EN50342-1			
W3	C2	V3	E1



TECHNICAL CHARACTERISTICS



BOX AND LID
PP



FLAMES ARRESTOR
Placed in the Lid

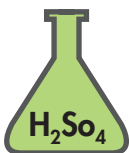

SULPHURIC ACID
Density
1,29+/- 0,01g/ml
Approximate volume 4,2 l

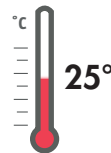

TEMPERATURE
According to EN50342-1



BATTERY WEIGHT
19,1 ±5% Kg

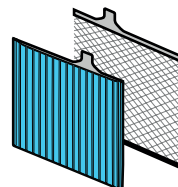

PLATES
Expanded grids in
Pb/Ca alloy